

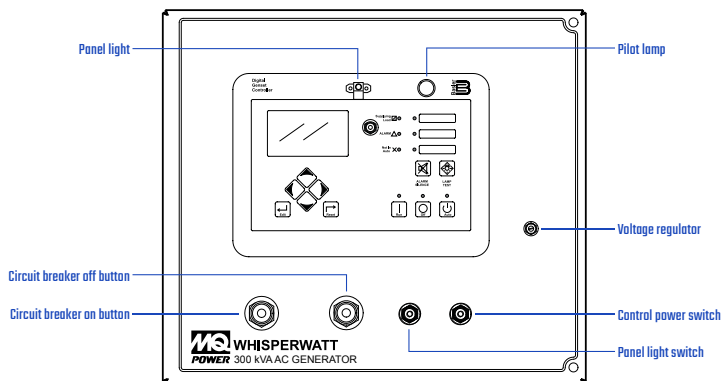

### Generator Control Panel

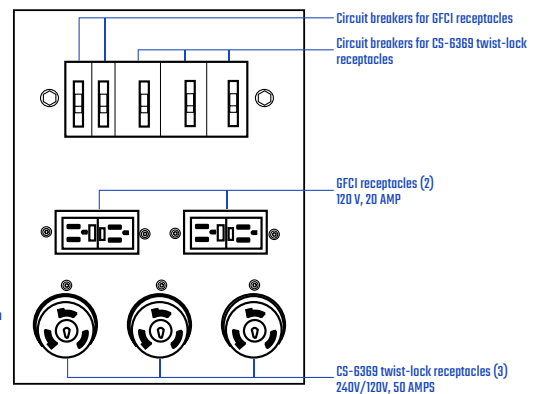

### Generator Output Panel



### DCA300SSJU4F3PB Weights\*

Dry Weight	11,155 lbs. (5,060 kg)
Wet Weight	14,815 lbs. (6,720 kg)
Max. Lifting Point Capacity	19,000 lbs. (8,618 kg)

\* Weights do not include options

### DCA300SSJU4F3PB Dimensions (with trailer)

Length	222.64 in (5655 mm)
Width	99.5 in (2527 mm)
Height	129.57 in (3291 mm)





**AXIS**  
PORTABLE AIR

**DCA300SSJU4F3PB**  
**GENERATOR SPECIFICATIONS**

**240kW**

Generator Specifications	
Design	Revolving field, self-ventilated Drip-proof, single bearing
Armature Connection	Star with Neutral
Phase	3
Standby Output	264 KW (330 KVA)
Prime Output	240 KW (300 KVA)
3Ø Voltage (L-L/L-N) Voltage Selector Switch at 3Ø 240/139	208Y/120, 220Y/127, 240Y/139
3Ø Voltage (L-L/L-N) Voltage Selector Switch at 3Ø 480/277	416Y/240, 440Y/254, 480Y/277
1Ø Voltage (L-L/L-N) Voltage Selector Switch at 1Ø 240/120	N/A
Power Factor	0.8
Voltage Regulation (No load to full load)	±0.5%
Generator RPM	1800
Frequency	50/60 Hz
Winding Pitch	2/3
No. of Poles	4
Excitation	Brushless with AVR
Frequency Regulation: No Load to Full Load	Isosynchronous under varying loads from no load to 100% rated load
Frequency Regulation: Steady State	±0.25% of mean value for constant loads from no load to full load
Insulation	Class F
Sound Level dB(A) Full load at 23 feet	72

Engine Specifications	
Make / Model	John Deere / 6090HFG06
Emissions	EPA Tier 4 Final Certified
Starting System	Electric
Design	4-cycle, water cooled, direct injection, turbocharged, charge air cooled, EGR, DOC, and SCR
Displacement	549.2 in <sup>3</sup> (9.0 liters)
No. cylinders	6
Bore x Stroke (mm)	4.64 x 5.34 in. (118.4 x 136 mm)
Gross Engine Power Output	437 hp (326 kW)
BMEP	320 psi (2212 kPa)
Piston Speed	1606 ft/min (8.16 m/s)
Compression Ratio	16.0:1
Engine Speed	1800 rpm
Overspeed Limit	2070 rpm
Oil Capacity	9.3 gallons (37 liters)
Battery	12V 430Ah x 1

Fuel System	
Recommended Fuel	ASTM-D975-No.1 & No.2-D*
Maximum Fuel Flow (per hour)	43 gallons (163.1 liters)
Maximum Inlet Restriction (Hg)	5.9 in (150 mm)
Fuel Tank Capacity	430.6 gallons (1630 liters)
<b>Fuel Consumption</b>	<b>gph</b> <b>lph</b>
At full load	16.7      63.2
At 3/4 load	12.5      47.4
At 1/2 load	8.9      33.8
At 1/4 load	5.8      21.9
DEF Tank Capacity	29.8 gallons (112.8 liters)

\* Use ultra-low sulfur diesel fuel

Cooling System	
Fan Load	26.8 hp (20 kW)
Coolant Capacity (with radiator)	17.7 gallons (67 liters)
Coolant Flow Rate (per minute)	102 gallons (385 liters)
Heat Rejection to Coolant (per minute)	10,473 Btu (11.05 MJ)
Maximum Coolant Friction Head	8.7 psi (60 kPa)
Maximum Coolant Static Head	78.7 ft. (24.1 m)
Ambient Temperature Rating	104°F (40°C)

Air	
Combustion Air	742 cfm (21 m <sup>3</sup> /min)
Maximum Air Cleaner Restriction	25 in. H <sub>2</sub> O (6.25 kPa)
Alternator Cooling Air	2797 cfm (79 m <sup>3</sup> /min)
Radiator Cooling Air	11,800 cfm (334.1 m <sup>3</sup> /min)

Exhaust System	
Gas Flow (full load)	1448 cfm (41 m <sup>3</sup> /min)
Gas Temperature	831°F (444°C)
Maximum Back Pressure	116 in. H <sub>2</sub> O (29 kPa)

Amperage	
Rated Voltage	Maximum Amps
1Ø 120 Volt	666.7 Amps (4 wire)
1Ø 240 Volt	333.3 Amps (4 wire)
3Ø 208 Volt	722 Amps
3Ø 240 Volt	722 Amps
3Ø 480 Volt	360 Amps
Main Line Circuit Breaker Rating	800 Amps
Over Current Relay Trip Set Point 480V Mode Only	361 Amps

PowerBalance Load Bank	
Rated Voltage	Maximum Amps
kW Rating	84
3Ø 240/480 Volt	202/101 Amps
Fuses	300 Amps x 3

